

# Hollow Metal Doors

FIRE RATED

## SPECIFICATIONS

<b>Door</b>	18 GA. Cold-rolled Steel
<b>Paint</b>	Prime painted
<b>Hinge Prep</b>	Non-handed 4-1/2" 7 GA. Can accommodate heavyweight hinges
<b>Construction</b>	Laser-Welded Edge Seam
<b>Channels</b>	16 GA. Inverted Top and Bottom
<b>Insulation</b>	Polystyrene Core
<b>Top Cap</b>	18 GA. Flush
<b>Edges</b>	Square hinge and lock edges
<b>Closer Reinforcement</b>	14 GA. Cold-rolled Steel

## OPTIONS

<b>Door Types</b>	Flush;
<b>Lock Preps</b>	161, 86 edge and RIM / SVR
<b>Galvannealed Steel</b>	ASTM A653 / A653M-A60

## CERTIFICATIONS

3 Hour Intertek / Warnock Hersey,  
 UL 10(b) (2008): NFPA 252 (2022):  
 UL 10(b) Revision 1 (2009): UL 10(c) (2016):  
 Ed.3(R:27 May 2021) CAN / ULC S104 (2015):  
 Built to SDI Specifications ANSI A250.8

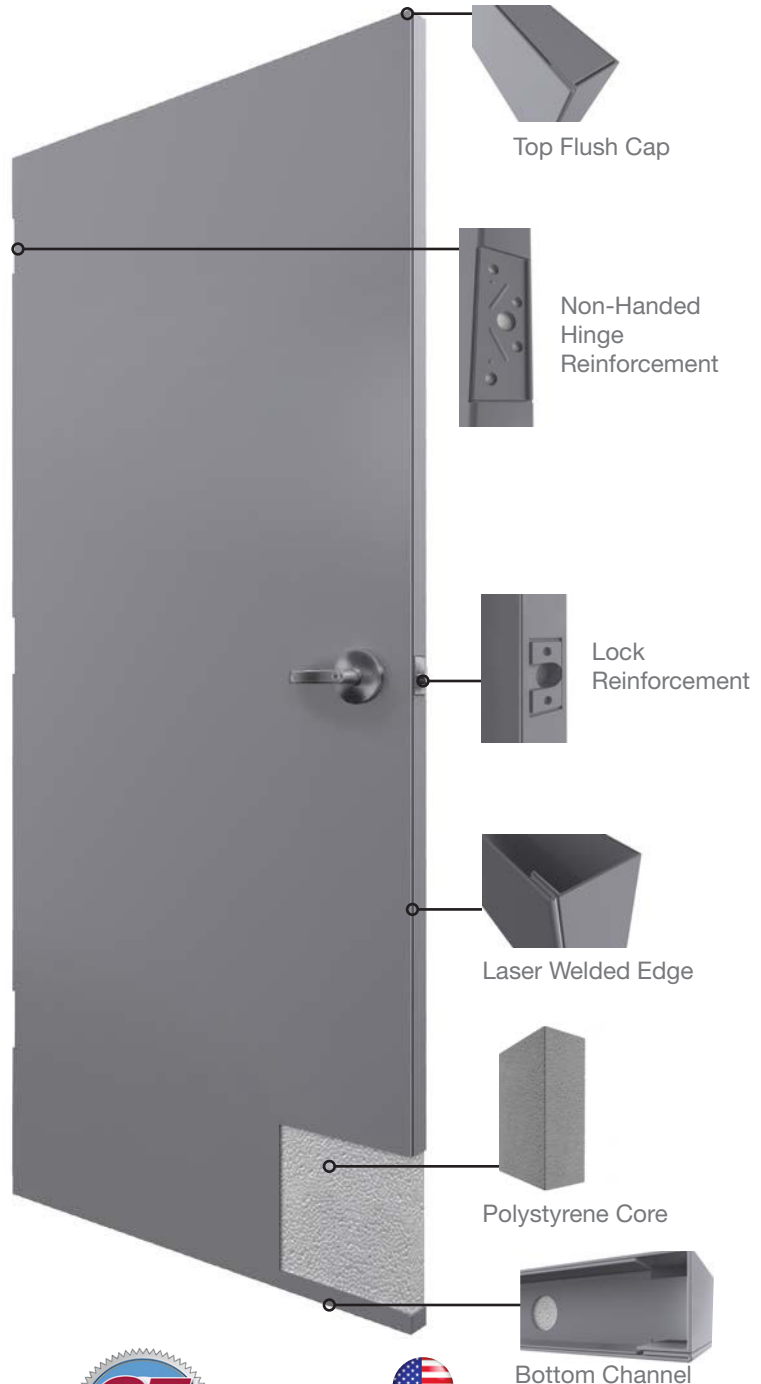

DeanSteel Manufacturing Company  
 931 S. Flores St.  
 San Antonio, TX 78204

P 800.825.8271  
 F 210.226.0913  
[www.DeanSteel.com](http://www.DeanSteel.com)



MADE IN AMERICA  
 AND VETERAN OWNED

## Door Dimensions

### 3068 Door

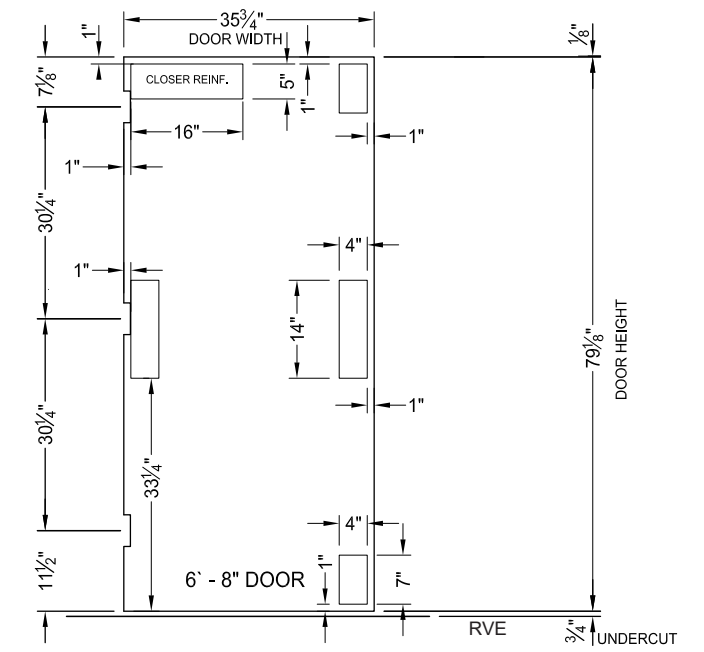
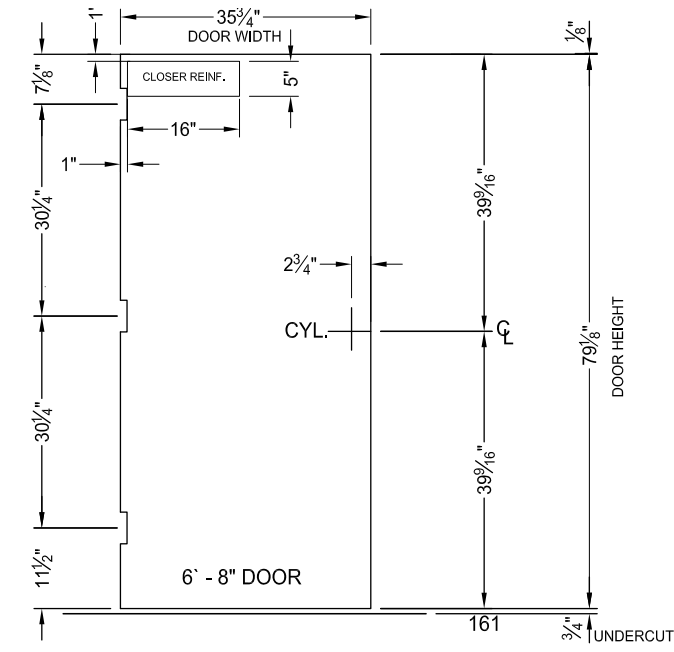

### 3070 Door

